

PLUG DETAIL

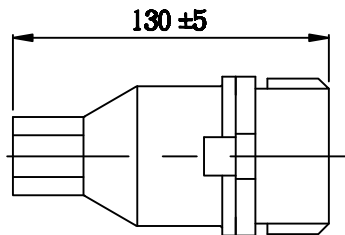

TABLE-A #

SL. NO.	RATING
01.	16A. 250V. P+N+E (3 PIN)
02.	25A. 250V. P+N+E (3 PIN)
03.	25A. 415V. 3P+E (4 PIN)
04.	25A. 415V. 3P+N+E (5 PIN)
05.	32A. 415V. 3P+E (4 PIN)
06.	32A. 415V. 3P+N+E (5 PIN)

TECHNICAL DATA

ENCLOSURE :-  
EX-d AS PER IS/IEC 60079-1:2007

PROTECTION :-  
IP-66 AS PER IS 12063-1987 (IS/IEC 60529:2001)

AREA CLASSIFICATION :-  
ZONE -1 & 2

TEMPERATURE CLASS :-  
T6

GAS GROUPS :-  
IIA, IIB & IIC

MATERIAL OF CONSTRUCTION :-  
DIE CAST AL. ALLOY LM-6

HARDWARE :-  
STEEL ZINC PLATED/STAINLESS STEEL

FINISH :-  
LIGHT GREY | YELLOW  
FOR IIA & IIB | FOR IIC

EARTHING :-  
1 NO. INSIDE & 2 NOS. OUTSIDE

CABLE ENTRY :-  
3/4"ET - 02NOS.

09.	WIRE BUSH	1	GLASSFEEL NYLONE
08.	TERMINAL	A.R.	CLIPON TYPE RAIL MOUNTED
07.	GASKET (ENDLESS, MOULDED)	2	NEOPRENE
06.	SWITCH 3PIN/4PIN/5PIN	1	TABLE-A #
05.	TERMINAL BOX COVER	1	DIE CAST AL. ALLOY
04.	PLUG 3PIN/4PIN/5PIN ASSEMBLY	1SET.	DIE CAST AL. ALLOY
03.	SOCKET 3PIN/4PIN/5PIN ASSEMBLY	1SET.	DIE CAST AL. ALLOY
02.	SOCKET COVER	1	DIE CAST AL. ALLOY
01.	BODY	1	DIE CAST AL. ALLOY
NO.	DESCRIPTION	QTY	MAT./RATING

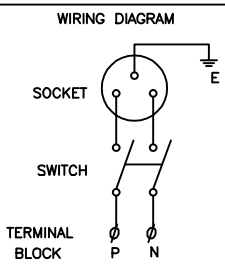

CLIENT	DRAWN	MBP
CONSULTANT	CH'D	MBP
P.O.No.	APP'D	MBP

DESCRIPTION:-  
FLAMEPROOF WEATHERPROOF SWITCH SOCKET

ISSUE	DATE	BY	MODIFICATION



1802/7, G.I.D.C. ESTATE,  
V.U.NAGAR 388121. (GUJARAT)

SHT.NO.	REV.	DRG.NO.:-
1 OF 1	0	F01